

ELECTRICAL REQUIREMENT		
STANDARD EQUIP.	VOLTS	FULL LOAD AMPS
(10) 4 Tube T-8 Light Fixtures	115-277	0.9-0.45 each
(1) 2 HP Exhaust Motor	208-230V/3Ø	5.77-5.22 @ 50

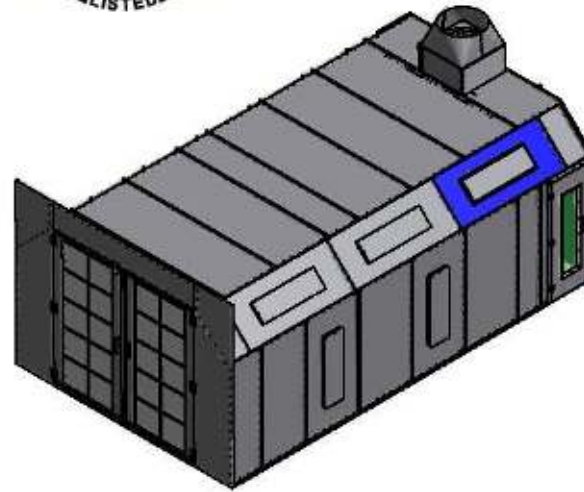

- SPRAY BOOTH PERMIT REQUIREMENTS:**
- (1) AIR AND FIRE SUPPRESSION OR SPRINKLERS TO BE INSTALLED BY LOCAL CONTRACTOR ON SEPARATE PERMIT.
  - (2) SPRAY BOOTH TO BE SEPARATED FROM OTHER OPERATIONS BY NOT LESS THAN 2' OR 5' WALL OR PARTITION, INTERIOR SURFACES SMOOTH AND CONTINUOUS.
  - (3) AIR SHALL EXHAUST OUT IN 10' OF THE FLOOR TO PICKUP FLAMMABLE VAPORS.
  - (4) MECHANICAL VENTILATION SHALL BE KEPT IN OPERATION AT ALL TIMES WHILE SPRAYING OPERATIONS ARE CONDUCTED AND FOR A SUFFICIENT TIME THEREAFTER TO ALLOW VAPORS FROM DRYING COATED ARTICLES AND FINISHING MATERIAL RESIDUE TO BE EXHAUSTED.
  - (5) AIR VELOCITY SHALL BE DESIGNED, INSTALLED AND MAINTAINED SUCH THAT THE AVERAGE AIR VELOCITY ACROSS THE FILTER SECTION OF THE SPRAY BOOTH DURING SPRAYING SHALL BE NOT LESS THAN 100 LM. FPM.
  - (6) ELECTRIC MOTORS DRIVING EXHAUST FANS SHALL NOT BE PLACED IN BOOTHS OR DUCTS. FANS ROTATING ELEMENTS SHALL BE NON-FERROUS OR NON-SPARKING OR CASING SHALL BE LINED WITH SUCH MATERIAL.
  - (7) BELTS SHALL NOT ENTER BOOTHS OR DUCTS UNLESS BELTS AND PULLEYS WITH IN A DUCT OR BOOTH ARE THOROUGHLY ENCLOSED.
  - (8) ELECTRICAL GROUNDING IS REQUIRED FOR METAL PARTS OF SPRAY BOOTH, EXHAUST DUCTS AND PIPING SYSTEMS, CONFORMING CLASS I OR II DEPENDS IN ACCORDANCE WITH THE ELECTRICAL CODE.
  - (9) ELECTRICAL INTER LOCK IS REQUIRED SO THAT SPRAYING CANNOT BE CONDUCTED UNLESS THE VENTILATION FANS ARE IN OPERATION VIA AIR SILENCER.
  - (10) INSIDE THE BOOTH ELECTRICAL SHALL BE CLASS DIV 1.
  - (11) ALL ELECTRICAL COMPONENTS ARE ILLUSTRATED.
  - (12) CLOSED BOOTH OPENINGS ARE CONSIDERED CLASS DIV 1 WITHIN 3' OF THE OPENINGS.
  - (13) NO SMOKING OR WELDING SIGNS SHALL BE POSTED WITH LARGE LETTERS AND A CONTRASTING BACKGROUND IN ALL SPRAY AREAS AND PAINT STORAGE ROOMS.
  - (14) ALL BOOTH IS MEET OR EXCEED NFPA 300-UMC-IFC-UBC CODES.
  - (15) SPRAY ENCLOSURE TECHNOLOGIES AUTO SPRAY BOOTH ARE ETL LISTED #3000457-001 AND OPEN FACE SPRAY BOOTH ARE ETL LISTED #3027070-001 MERCURY HEATER ETL LISTED REPORT # 2001072008.
  - (16) FLOOR MUST BE FLAT AND LEVEL ± .001"

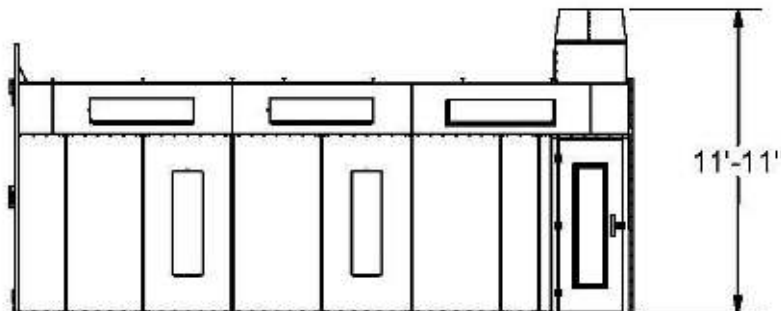
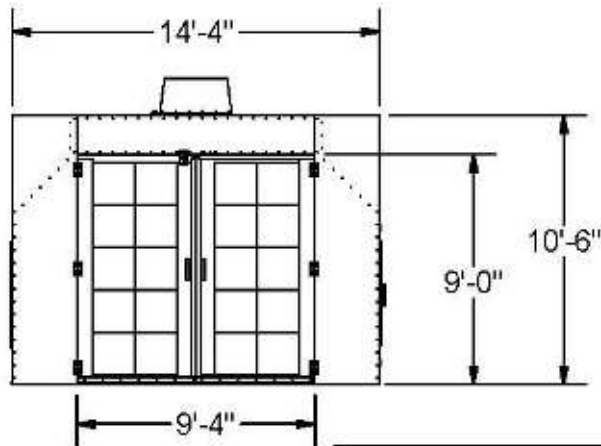
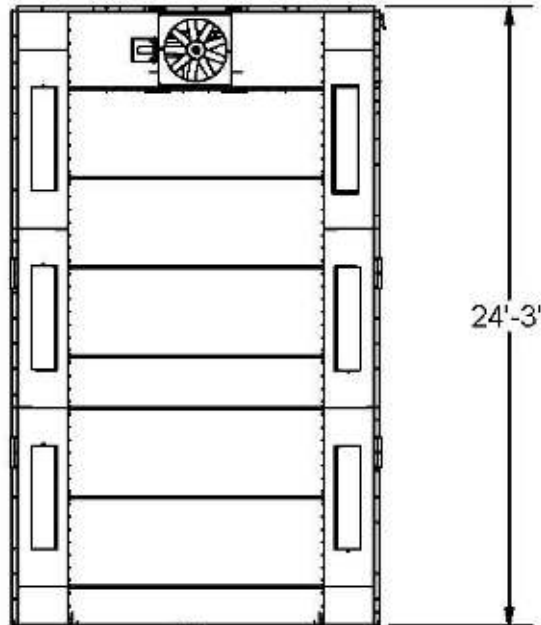

 www.spraytech.com	PART NUMBER : SF23149I	MATERIAL:	FINISH:	CITY:
	DESCRIPTION: Front Flow Automotive Spray Booth w/ Inside Plenum, 24' Outside Length			
CREATION DATE: 2/16/2004	DRAWING NUMBER : SF23149I-Spec.idw			