

Parts List				
ITEM	QTY	PART NUMBER	MATERIAL	DESCRIPTION
1	1	Booth Rear Wall - New Style Panels		Rear Wall for Premier Booths, 128.33"H x 172.38"W
2	2	CCHANNEL044	18 GA GALV STEEL	C-Channel for Insulated Booths 2" wide x 124.1" long
3	2	CCHANNEL083	18 GA GALV STEEL	C-Channel for Insulated Booths 2" wide x 102.497" long
4	4	CCHANNEL102	18 GA GALV STEEL	C-Channel for Insulated Booths 2" wide x 102.497" long
5	4	CCHANNEL126	18 GA GALV STEEL	C-Channel for Insulated Booths 2" wide x 124.1" long
6	1	GRATEDFL-24		—Fully Grated Floor upgrade to Down Draft Booth measuring 14' x 24' for Pit Installation Not for raised Basement
7	1	JA 26K DD AHP Assembly Flow MIR		Air Make Up System For Jun Air Booth
8	1	JA FceTri		JunAir Facia with Tri-Fold Doors and Long Windows
9	4	C Channel 126-3	18 GA GALV STEEL	C-Channel for Jun Air Insulated Booths 2" wide x 126" long
10	1	I28128P		32.375 x 126
11	1	JA InsMnCvrAssyD1		Insulated Men Door Cover Panel, 48.037"H x 35.942"W
12	1	JA38020300-RL		Mandoor Assy-New Style (RIGHT OR LEFT)
13	4	JA101601	18 GA GALV STEEL	JA Type Panel, 1.00x6.41-15.00LG Angle, Tek Holes
14	1	JA428DD-91424 Ceiling		JA428DD-91424 Ceiling, 27'L x 14'W
15	2	JA606301	18 GA GALV STEEL	JA Type Panel, 2.00x6.50-63LG Angle, Tek Holes
16	4	JA812004	18 GA GALV STEEL	JA Type Panel, 2.00x6.50-102.531LG Angle, Tek Holes
17	2	MQ1287QADPN-Left		QADS Tower, (8) Nozzle with Pneumatic Cylinder and Nozzle Cover
18	2	MQ1287QADPN-Right		QADS Tower, (8) Nozzle with Pneumatic Cylinder and Nozzle Cover
19	16	Rear Wall-Middle		Middle Rear Wall Assembly 33"W x 128"L

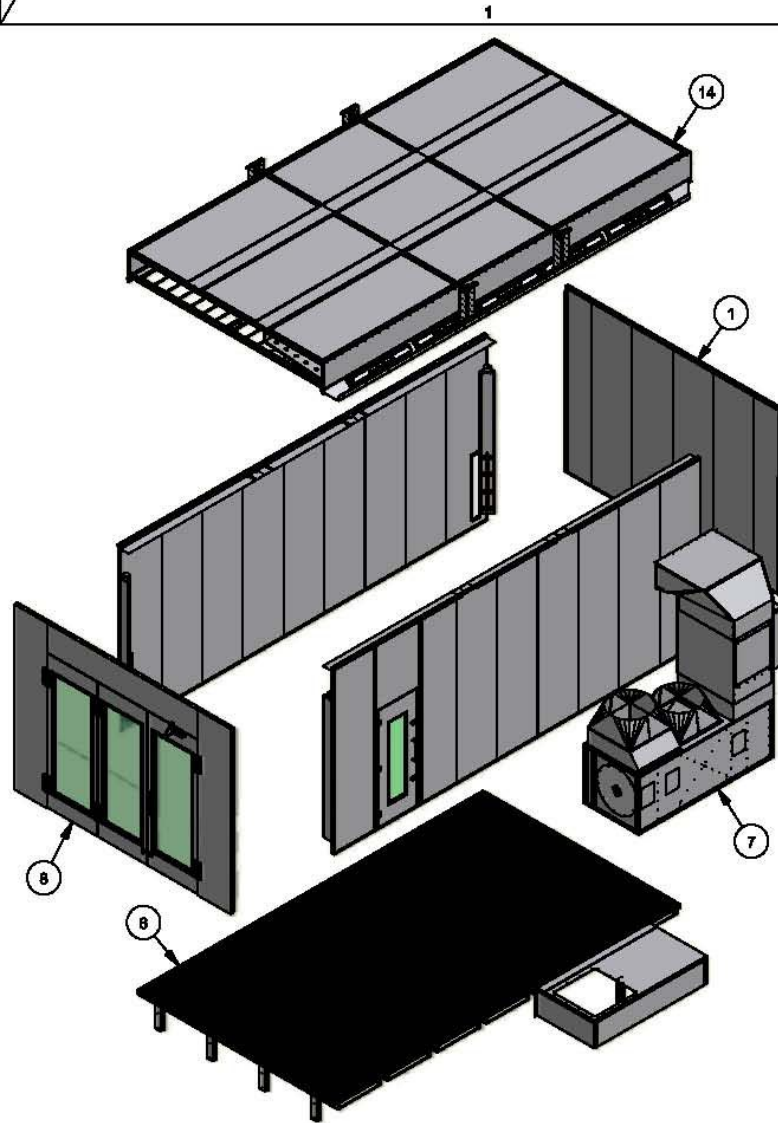
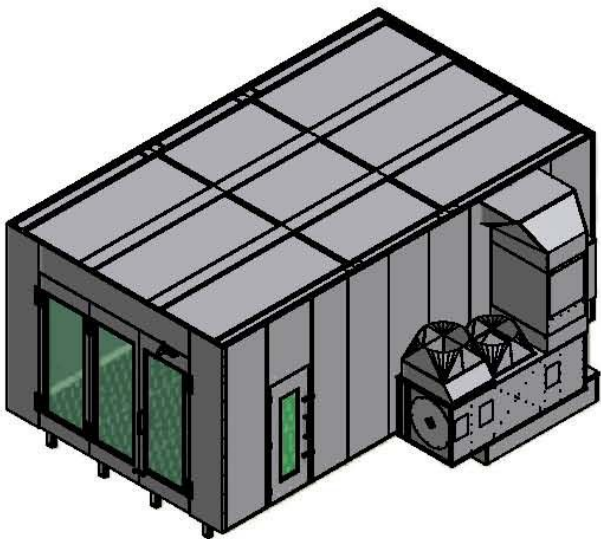

PUNCH PRESS	BREAK	WELD	POWDER COAT	SHIPPING
PART NUMBER: JA428DD-91424			MATERIAL:	QTY
DESCRIPTION: Junair Americas Model 428 Spray Booth. Inside dimensions 8'H x 14'W x 24'L				
DRAWN BY: Johnny		DATE: 4/24/2008		CUSTOMER:
CHECKED BY:		DATE:		
SIZE: A	USED ON:	REV:	SHEET 1 OF 3	
DRAWING LOCATION: C:\vault\work\Designs\Units\Jun Air\Junair Americas\JA428DD-91424 X-View.idw				